

# TTB-EC100.012 - TTB-EC100.024 - TTB-EC100.024-2W

## Eigenschaften

Construction	Tubular, without fan
Size	Ø 80 mm
Power	140 W S2 (100 W S1)
Magnets	2
Bearings	Ball bearings
Mounting holes	4
Power supply	Low voltage, 12 or 24 Vdc
Brushes	2 inside brushes made of graphite/copper composite
Brushes size	LxWxH = 17.1 x 6.5 x 16.7 mm
Electric cable	Length: 1000 mm
Rear shaft	Standard only EC100.24E

Tipo Type	S	Pn [W]	V [V]	I [A]	IC	FF	Mn [Nm]	n <sub>1</sub> [min <sup>-1</sup> ]	IP	Kg	
EC100.120	S1	100	12	12	F	1	0.31	3000	40	2.7	
	S2 25%	140		16.8			0.43				
EC100.024	S1	100	24	6			0.31				20
	S2 25%	140		8.4			0.43				
EC100.024-2W	S1	100	24	6			0.31				
	S2 25%	140		8.4			0.43				

## Abmessungen

### EC100.012 EC100.024

56 B14	
L	153
D	80
S	65
C (-0.03 / -0.01)	50
63 B14	
L	155
D	90
S	75
C (-0.03 / -0.01)	60

\* Use sleeve 9/11

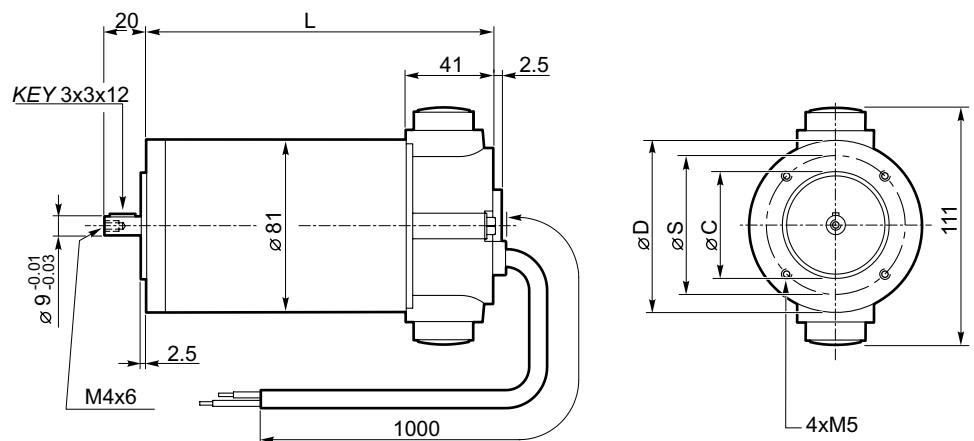

### EC100.024-2W

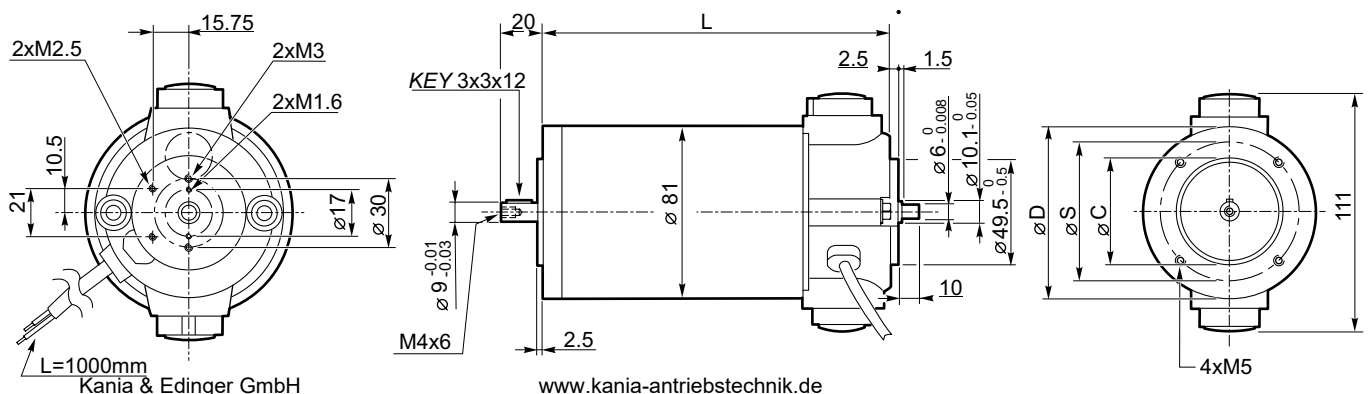

# TTB-EC100.012 - TTB-EC100.024 - TTB-EC100.024-2W

## Performance

### TTB-EC100.012

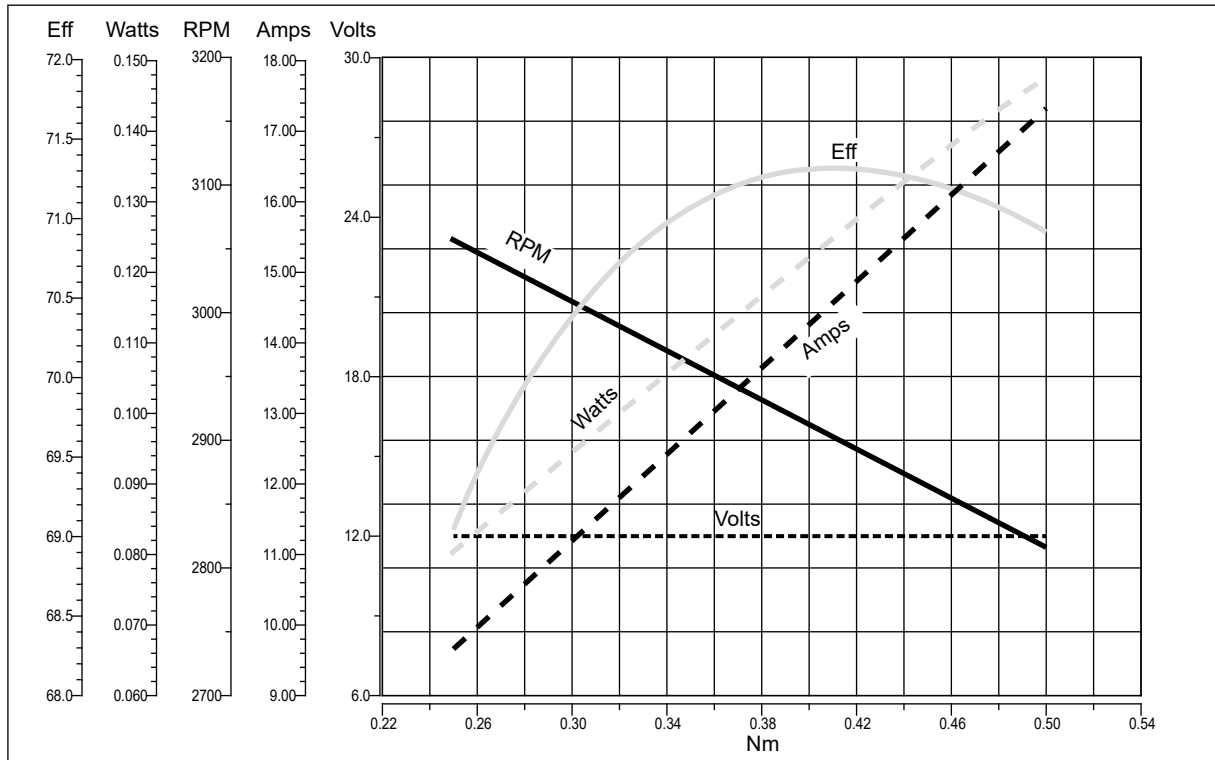

### TTB-EC100.024

